

BOSS

USER'S MANUAL BOSS Beds 950



<http://bossbeds.ca>

BOSS

Table of Contents

Safety Instructions	01
Parts List	03
Under Bed View	04
Electronics Overview	05
Installation	06
Wireless Remote Control	08
APP Use Guide	11
Audio and USB Charge Use Guide	12
Remote Pairing	13
Memory Setting	14
Setting Up Two Bases..	15
Headboard Brackets Installation	16
Trouble Shooting.....	17



Safety Instructions

Safety Disclaimer

Thank you for purchasing a Bossbeds adjustable bed base. For your safety, please read all instructions carefully before using this adjustable base. Save these instructions for future reference.

Attention:

Keep the base unplugged from the electrical outlet before operating any part of the base. To prevent the risk of electric shock, always unplug the base before cleaning. For your safety, ensure the base is in a flat position with all motors turned off, disconnected from the power source, and keep the power cord away from heated surfaces.

If the power cord or plug becomes damaged, or if the bed base is wet or not working properly, stop using the bed base and contact customer service

This bed base is intended to be used only as described in this manual. Do not use any accessories/attachments that are not recommended by the manufacturer. Close supervision is required when the bed base is used by or near children, convalescents or disabled persons.

Electrical Safety: Connect to a surge protector (not included).

Please ensure you connect the base properly to the power supply. Any incorrect power connection may cause electric Shock or Fire. **FOR OPTIMAL SAFETY, YOUR ADJUSTABLE BED SHOULD BE PLUGGED INTO A SURGE PROTECTOR** (not supplied with this adjustable bed). Always unplug this adjustable bed frame from the electrical outlet before any cleaning or maintenance of the bed frame. To safely disconnect, remove the plug from the outlet. Keep cord away from heated surface. Use only indoors.

The control box, motors, and remote (except battery compartments) should not be opened or tampered with. Opening or tampering with these components without authorization will void the warranty.

In-Home use only

Bossbeds adjustable bed bases are designed exclusively for in home use only.
Do not use this base with oxygen therapy equipment or near explosive gases.

Pacemaker Notice:

This bed base contain neodymium magnets which may interfere with magnetic fields of devices such as pacemakers, ICD'S etc. Some pacemakers may falsely interpret the optional massage vibrations as movement or exercise. The owner of such medical devices should consult their physician before using this product.

Children and Pets:

This product is designed to be used by an adult. Do not allow children to operate this bed without adult supervision. Immediately dispose of all packing materials as they can pose a smothering risk to children and pets. Injury could occur if children or pets are permitted to play on or under the bed.

<http://bossbeds.ca>

BOSS

Safety Instructions

Product Ratings:

The lift motors are not designed to operate continuously for more than (2) minutes in an (18) minutes time period. Attempting to circumvent or exceed this rating will shorten the life expectancy of the product and may void the warranty.

Weight Limits:

This product is not rated to support weights exceeding 385 kgs including the mattress and bedding. The base will structurally support this weight, provided it is evenly distributed across the bed base. The adjustable base is not designed to support or lift this amount in the head or foot sections alone. Exceeding this weight restriction could damage the bed and/or cause injury and will void the warranty.

Acoustics:

The massage function will emit a noticeable tone during operation. As the massage intensity level is increased, the tone will intensify. The volume of this tone is directly related to the location environment. For example, when demonstrated in a show room, the surrounding environmental noise will cover some of the massage noise. However, when installed in a home setting with wooden floors, carpeted or not, the massage volume will be more noticeable. In normal base operation, the legs support of the base will create a contact noise with the floor. When entering, exiting, or shifting weight on the base, this contact noise may be louder as the legs make contact. This is normal.

Fabric Care:

To prolong the life of your fabric, protect it from direct sunlight whenever possible. For spot cleaning, wipe the area with a light damp sponge or vacuum with a soft brush attachment to remove particles. Keep at a minimum of 30cm (12 inches) away from direct heat sources. For deeper cleaning, blot liquid spills with a clean dry cloth. Wipe with a clean cloth dampened with warm water. Do not moisten excessively. A soft bristle brush may be used to remove ingrained soil. Avoid scratching by brushing gently. Wipe with a clean cloth dampened with warm water to remove residues. Dry in a shaded area away from direct heat. If persistent marks remain visible after cleaning, seek professional advice.

FCC Compliance:

This device complies with part 15 of the FCC Rules. Operation is subject to the following two conditions: (1) This device may not cause harmful interference, and (2) this device must accept any interference received, including interference that may cause undesired operation.

To comply with the FCC RF exposure requirements, no change to the antenna or the device is permitted. Any change to the antenna or the device could result in the device exceeding RF exposure requirements and void the user's right to operate the device.

Radio Frequency: 2.4GHz



<http://bossbeds.ca>

BOSS

Parts List

Ensure you have received all the parts listed below before discarding the packing materials.

Parts List:

- A) Wireless Remote Control and AAA batteries [3]
- B) Legs and Washers (Note that the legs are two piece legs) [4]
- C) Mattress Retainer [1]
- D) Power Supply [1]
- E) Power Cord [1]
- F) Headboard Bracket [2]
- G) Headboard T-Bar [2]
- H) Large Washers [2]
- I) Long Bolts M8 [4]
- J) Short Bolt [8]
- K) Small Washers [12]
- L) Hex Key [1]
- M) Sync Cable [1] (Optional)
- N) Long Bolts M10 [2]
- O) Audio Cable [1]



<http://bossbeds.ca>

BOSS

Under Bed View

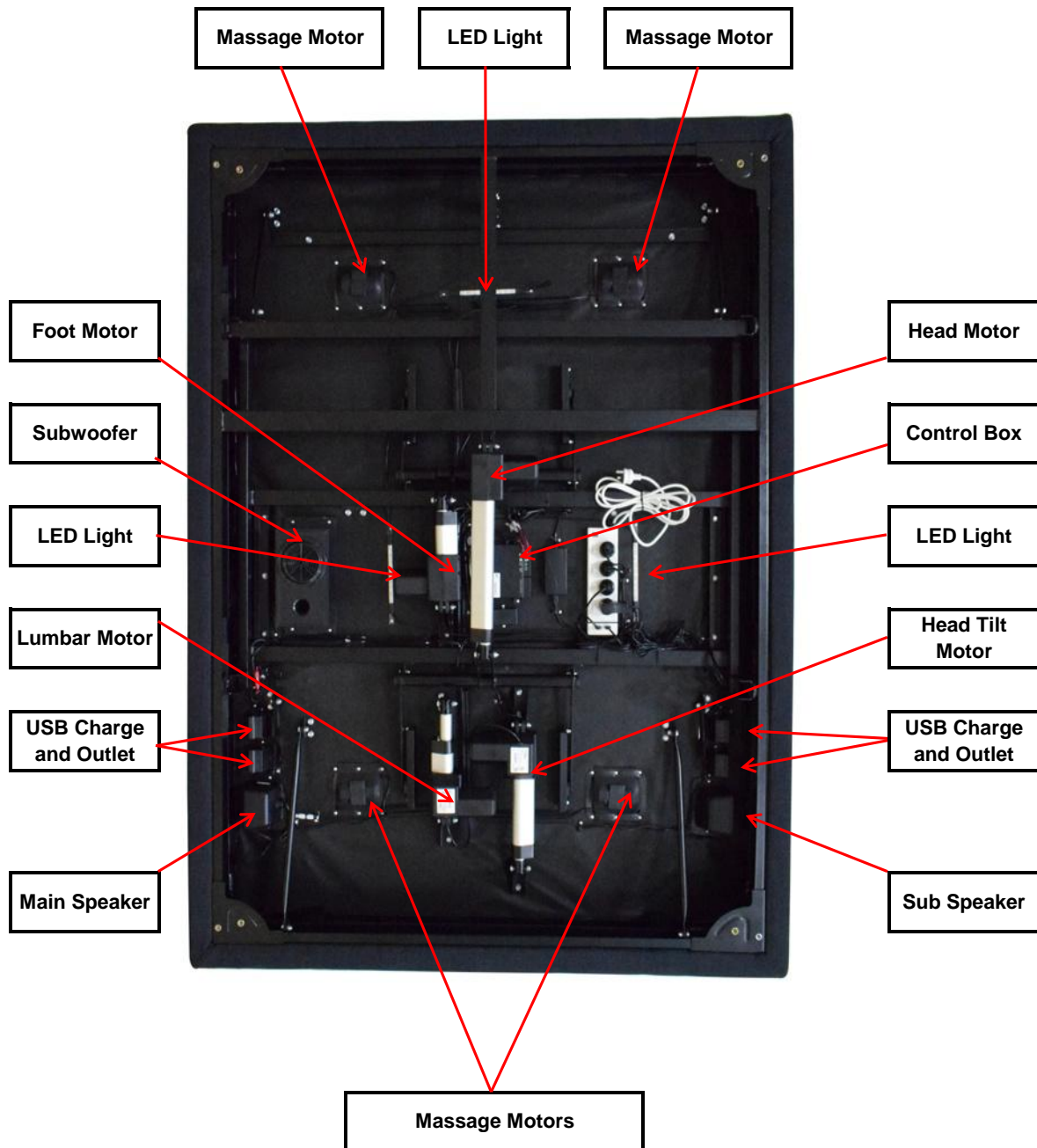

<http://bossbeds.ca>

BOSS

Electronics Overview

Not to Scale, Only for illustration purposes.
Read all illustrations and instructions before beginning the installation process.

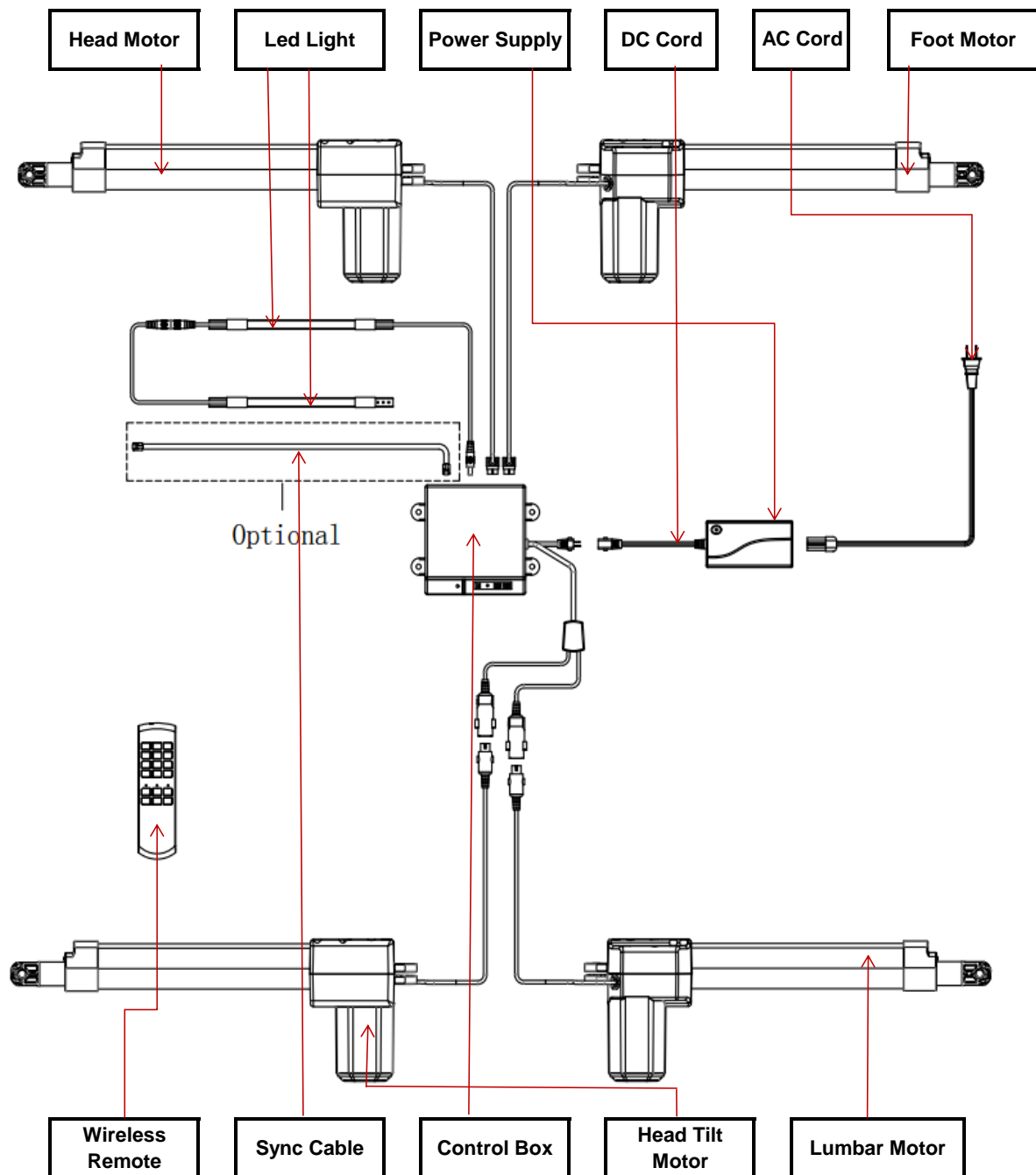

<http://bossbeds.ca>

BOSS

Installation

STEP 1: Remove packing materials

Put the bed base in a desired place with the bottom of the box facing up. Remove box cover, take out all of the packing materials and put aside, Make sure not to puncture the bed with any sharp objects.



STEP 2: Remove the bed from the box

Remove the bed base from the box keeping the bottom of the base facing upwards. Install the 4 legs to the four corners as shown. Tighten the legs by hand. Ensure the legs are secured tightly.

P.S. Install the headboard brackets at the same time if attaching to a headboard. See the page 16.



STEP 3: Overturn the bed base carefully

Carefully turn the base over using two people. Do not lay the base on its side to prevent damage to the side button, fabric or legs.



STEP 4: Connect power supply

Plug the power cord into the power supply as shown.



BOSS

Installation

STEP 5: Remote

After the base is connected to the power supply, install three AAA batteries into the remote battery compartment. See pages 9 and 10 to learn how to operate the remote.



STEP 6: Install mattress retainer

*Locate the mattress retainer as shown below [1];

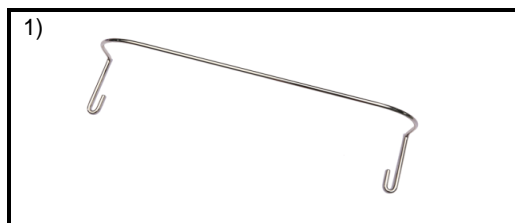

Insert the mattress retainer into the hooks at the foot of the bed as shown [2]]. Slide the mattress retainer into place. Ensure it is securely tightened [3]].

2)

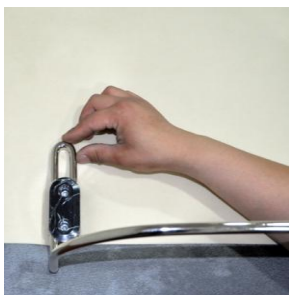

3)



BOSS

Wireless Remote Control

Remote Overview

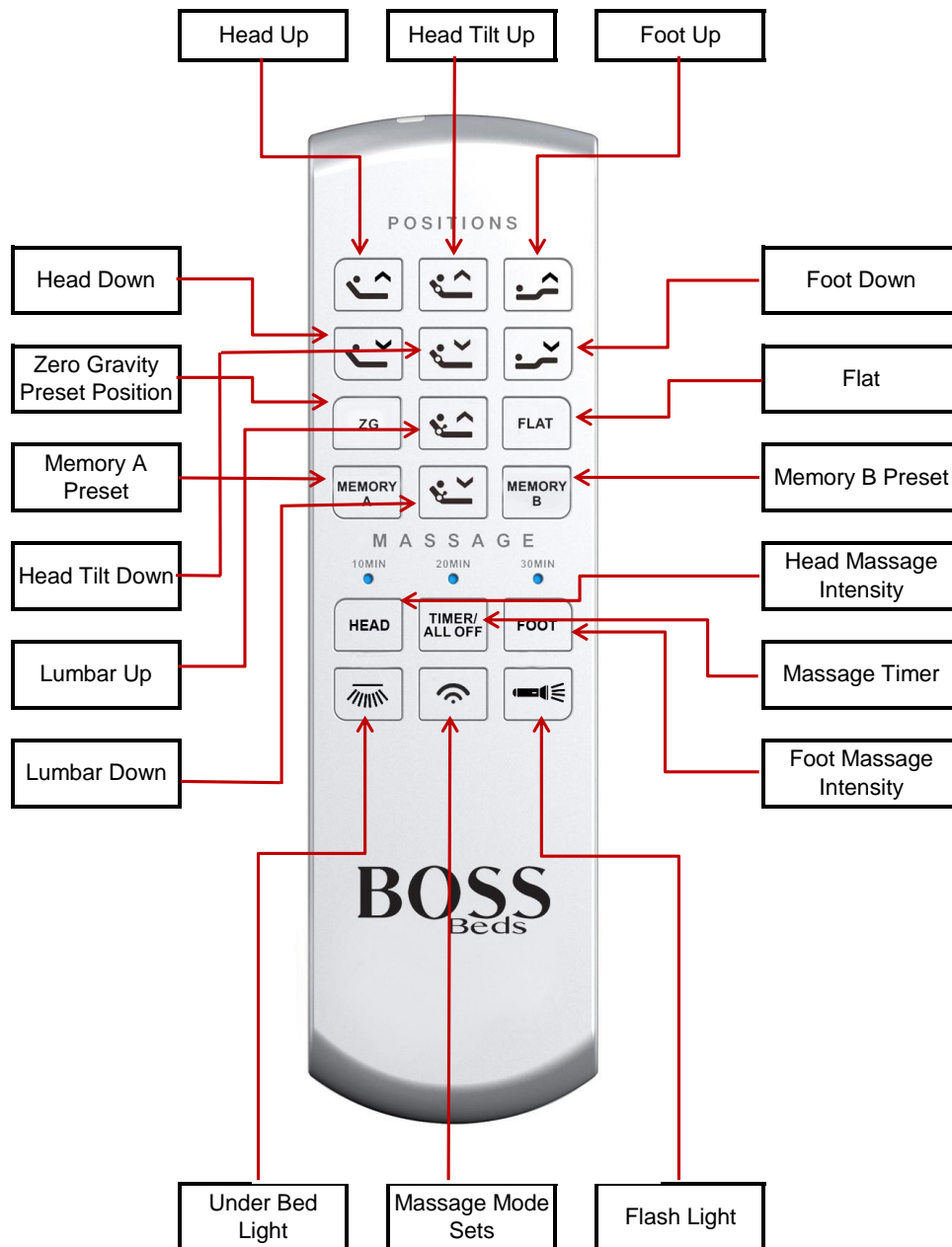

<http://bossbeds.ca>

BOSS

Wireless Remote Control

Adjusting Features



The HEAD UP/DOWN button raises/lowers the head section of the base



The FOOT UP/DOWN button raises/lowers the foot section of the base



The HEAD TILT UP/DOWN button customizes the level of head support



The LUMBAR UP/DOWN button customizes the lever of lumbar support



One touch ZERO GRAVITY preset position, adjust your legs to a higher level than your heart, to help relieve pressure off the lower back and promote body circulation



The one touch FLAT button returns the head and foot sections to a horizontal position.



One touch MEMORY A button allows you to preset your favorite position.



One touch MEMORY B button allows you to preset your favorite position.



Message Features



The HEAD button increases or decreases the head massage intensities



The FOOT button increases or decreases the foot massage intensities



The ALL/OFF button shuts off all massage features.



The MESSAGE model switch button, there are three massage models.

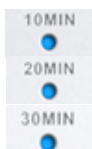

The buttons of 10MIN, 20MIN or 30MIN sets the massage feature to automatically shut off after 10MIN, 20MIN or 30MIN as set.



Turns on/off the light underneath the bed.



Turns on/off the flashlight that is on the remote.

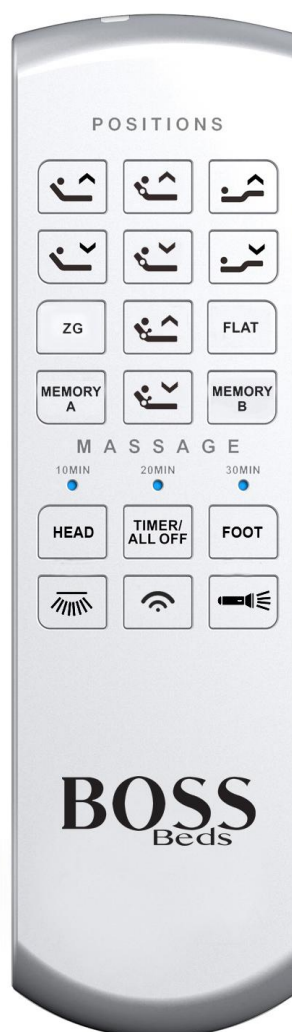

BOSS

APP Use Guide

Insure the smart device bluetooth turned on before using APP.

STEP 1:

Search "Bossbeds" in APP Store(for Apple devices) or Google Play(for Android), then install software into the smart device.

STEP 2:

Open Bossbeds APP, click (4M) BEDDING, will enter into POSITIONS page.

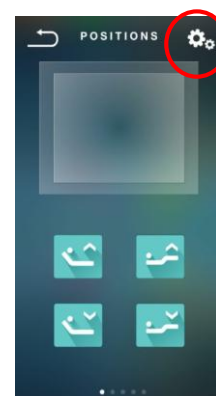
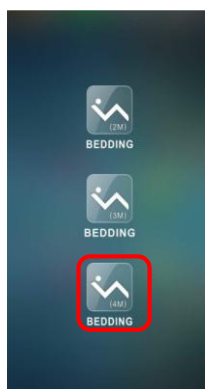

STEP 3:

Enter into the Settings page after click the setting button on the right of POSITIONS, select the target the bed with the named start of "ORE-*****", it will be connected.

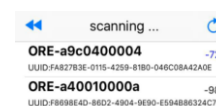
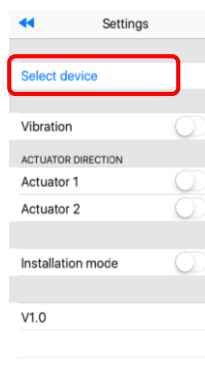

STEP 4:

Back to POSITIONS page, the smart device can act all functions the same as the remote.

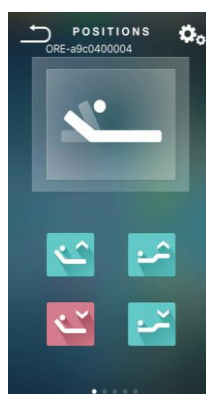

<http://bossbeds.ca>

BOSS

Audio and USB Charge Use Guide

Audio Guide

STEP 1: Bluetooth connect to base audio

Turn on smart device bluetooth, search the base signal start the name of "Bed Sound *****" and connect it. The base speaker shares all smart device audio synchronously.

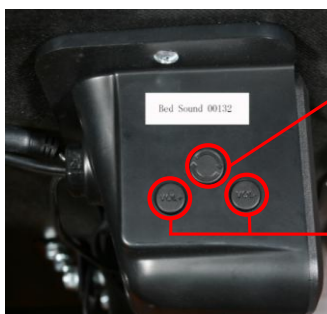

Bluetooth to Audio
Cable connection
swift button

Press button
"VOL+" / "VOL-"
increase/reduce the
voice respectively

STEP 2: Audio cable connect to base audio

Press switch button to use the audio cable connect the device to base audio instead of bluetooth. The base speaker shares all device audio synchronously.



Audio Cable

USB Charge And Outlet Guide

The USB charge and outlet on both side of head position under the base board can be used normally after the power supply connection.



Attention: disconnect the base from power supply and bluetooth connection when not planning to use the audio, USB charge and outlet function.

BOSS

Remote Pairing

Attention: All bases are set to the different DIP of the remote for easier use. You need to pair your remote if you need one remote controls two bases simultaneously. If using only one base normally, proceed to page 14.

STEP 1:

Press and hold the "LINK BUTTON" on the control box untill the LINK LED fashes, then release the "LINK BUTTON"



STEP 2:

Press and hold simultaneously the Head-Up button and Foot-Up button on the remote control until backlight LED flashes, then release the two buttons

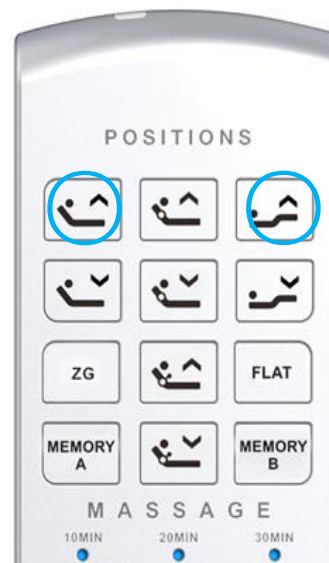

Very important: Pairing your device must be completed within 2 minutes; Make sure the other base in the room is powered off.

STEP 1:

Ensure the base is connected to the power supply correctly and the remote control works properly. Ensure the base is in the Flat position. Make sure the massage, LED light and other functions are turned off.

STEP 2:

Adjust the HEAD and FOOT to your desired position. Press the "TIMER/ALL OFF" button until all buttons on the remote are flashing.

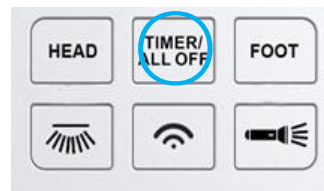

STEP 3:

While the buttons are flashing, press one of these three buttons including "MEMORY A"/"MEMORY B"/"ZG" until the flashing stops. The selected MEMORY FUNCTION is now set.

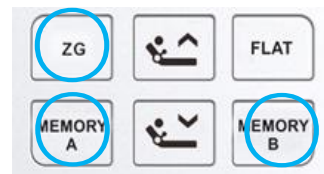

BOSS

Setting Up Two Bases

How to operate two bed bases simultaneously

STEP 1:

The sync cord is needed when connecting two CK or TXL bases together.

STEP 2:

How to synchronize the two bases:

Use the sync cord connecting base A control box in sync port with base B sync port.

Sync port: **SYNCHRO CNTL!**

STEP 3:

After synchronization, any of the remotes can control the two bases synchronously.



How to disable the synchronizing function

Unplug the sync cord connecting the two bases. The sync function is now disabled.

Remote A

Remote B

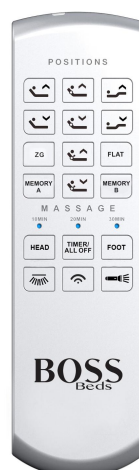

<http://bossbeds.ca>

BOSS

Headboard Brackets Installation

STEP 1:

Open the headboard bracket accessory package and confirm that all the pieces listed below are included:

Headboard Brackets [2]

Headboard Connecting Components [2]

Short Bolts (8)

Long Bolts M8 [4]

Large Washers [2]

Small Washers [12]

Hex Key [1]

Long Bolts M10 [2]

STEP 2:

Install the headboard bracket (F) using one long bolt (M10) and one large washer. Install as per the picture to the right. Use the Hex Key to tighten the bolts. Repeat this process for the other side of the base.

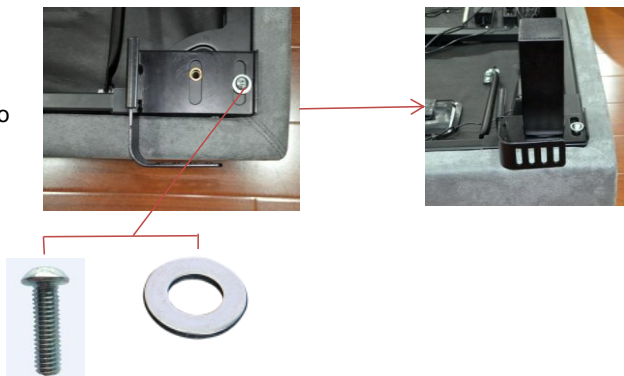

STEP 3:

Attach the headboard T-Bar (G) to the headboard bracket(F) using 4 short bolts and 4 small washers as per the picture to the right. Use the Hex Key to tighten the bolts. Repeat this process for the other side of the base.

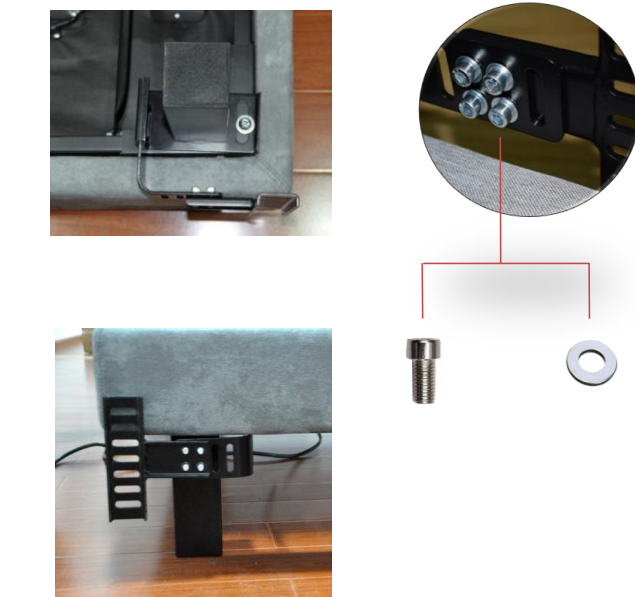

STEP 4

The remaining 4 pieces of long bolts (M8) and 4 pieces of small washers can be used to attach the headboard bracket to your headboard.

If one or more functions on the bed base have stopped operating, please check the bed as follow:

© Check under the bed base to verify that the wired connections are secure and that there are no cords or bedding obstructing the movement of the base.

© Check to see if the bed base is connected to the power supply correctly. Make sure the power supply is connected to the outlet.

© Ensure the batteries in the remote are new and operable.

© If the power supply is working correctly, unplug the base for 1 hour to reset the electronic components.

© After the electronic components have been reset, follow the REMOTE SETTINGS steps on page 13 to reset the base.